



TEMPORARY TRAFFIC ORDER

(Please Complete in Full and return to streetworks@gloucestershire.gov.uk)

APPLICANTS DETAILS –

Name Complete Utilities

Address Overton Farm, Maisemore, Gloucester, GL2 8HR

Contact Number 01452 500995

Email roadworks@completeutilities.co.uk

INVOICE DETAILS-

Name and Address for invoice (if different from above):

Contact Number

Email

Purchase Order/Ref no for invoice POC-007018

INSTRUCTING OFFICER AND TELEPHONE NUMBER – William Bellerby 8986

Traffic Order Details

Road number and local name: 401502 Hill Mill Lane

Closure Location: From: - Jctn C/284 Wortley Road

To: - Jctn 401502 Blacksmith Hill

Total Distance: - Approximately 1.8 Km

Districts – Stroud/Cotswold

Parish/Ward – Wotton-under-Edge/Ozleworth

Town - Wotton-under-Edge/Ozleworth

Type of Closure/Restriction: **(Indicate if emergency) (Attach schedule if complex/more than two roads affected by closure/restriction)**

Full Road Closure

Do any other Orders need to be suspended throughout these works? **No**

E.g. Lorry Management Zone Consolidation Order, One Way etc

(If ticked, please provide full title of the Traffic Road Order)

Reason for Request: - **(full as possible in plain English)** Gigaclear rural fibre installation. Road too narrow for vehicles to pass safely.

Dates/ Time Required: From 17.02.20 Until 30.03.20

Is Secretary of State Consent required? YES [] NO [x] **(If yes, please attach the completed application form).**

Proposed Alternative Route **(List Roads, including road number and local name) As signed on site.**

Pedestrian and emergency access should be maintained at all times other than in exceptional circumstances.

Please confirm that:

Emergency access is to be maintained YES [x] NO []

Pedestrian access is to be maintained YES [x] NO []

If NO to either, please explain why:

Declaration

I, hereby confirm my Authority to act on behalf of the Organisation as described above, and confirm our intent to comply with the Conditions as laid out overleaf.

Applicant Signed Mark Turner

Dated 16.12.19

Data Protection Act 1998 (as amended). This information is collected for the administration of Gloucestershire County Council. It may be provided to outside agencies and neighbouring authorities to advise them of the arrangements in place. If you have a query of concern regarding this, please contact the relevant Gloucestershire County Council Stakeholder

Conditions

The applicant must agree to:

1. Meet all the necessary legal, administrative and advertising costs of £1250.00

Plus £150.00 per any additional road on same application

£300.00 for deferral of start date. £300.00 for any extension to closure date

If the TTRO is cancelled before any adverts are placed a charge of £450.00 will still be made (admin and legal

2. Maintain pedestrian and emergency access at all times

3. Applicant must erect advanced warning notices (7008) at least 7 days before works commence (to include company name, date, duration and contact number)

4. Erect and maintain signs for the closure and the alternative route

5. Supply a minimum 12 weeks notice to Gloucestershire County Council

6. Indemnify Gloucestershire County Council against all claims including any third party claims in respect of the closure/restriction and its associated works.

7. Meet any additional costs incurred if changes are required to bus routes/timetables.

The only reasons for permitting a road closure/restriction are as follows: -

1. Works are to be executed on or near the highway.

2. Danger to the public or serious damage to the road.

3. Environmental reasons.

Further Notes

Works under a temporary traffic order must commence on the date given overleaf.

If the commencement of works is delayed by up to 7 days, further notices must be erected on site prior to the new commencement date.

If works are delayed between 7 and 28 days a further advertisement may be required. **Contact Gloucestershire County Council for information: -**

08000 514514

If works are delayed more than 28 days from the date of closure then the application process must be restarted giving a further 8 weeks notice.

Any changes to start or finish dates or to other details **MUST** be brought to the attention of the **Gloucestershire County Council**.

Emergency Notices

Emergency Notices cannot be given for planned works nor can they be processed in advance. This process must only be used for works that pose a danger to the public.

For Office Use Only

Financial Cost Centre Code: 302719/47700

(Capital, Revenue or recoverable)

Authority for an Order in the above terms given by;



Area Manager/Local Highway Manager (please delete as appropriate)

Phil Cameron (Printed Name) PHIL CAMERON

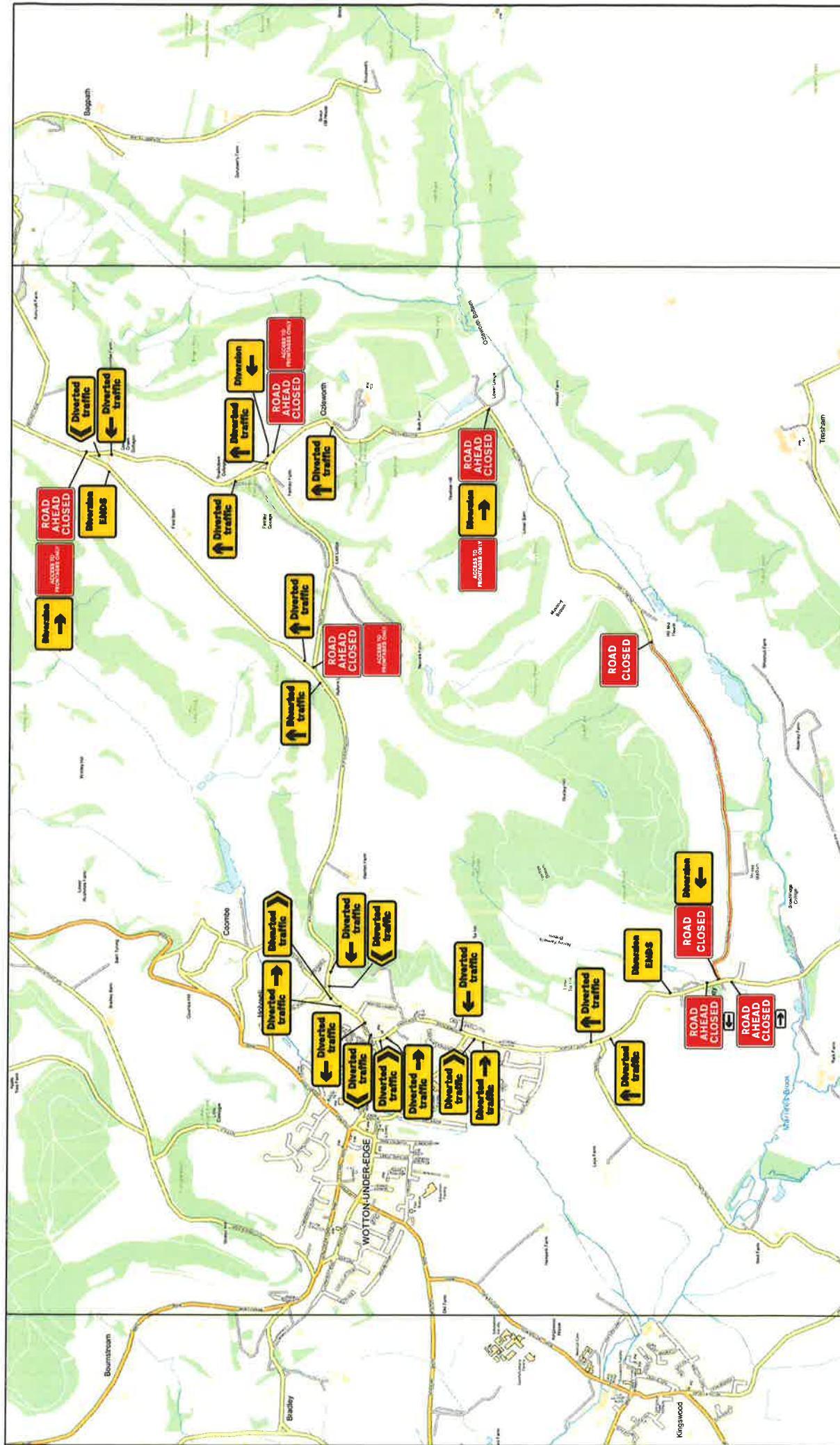

Co-ordinator [Signature]

Date of Authority 30-12-19

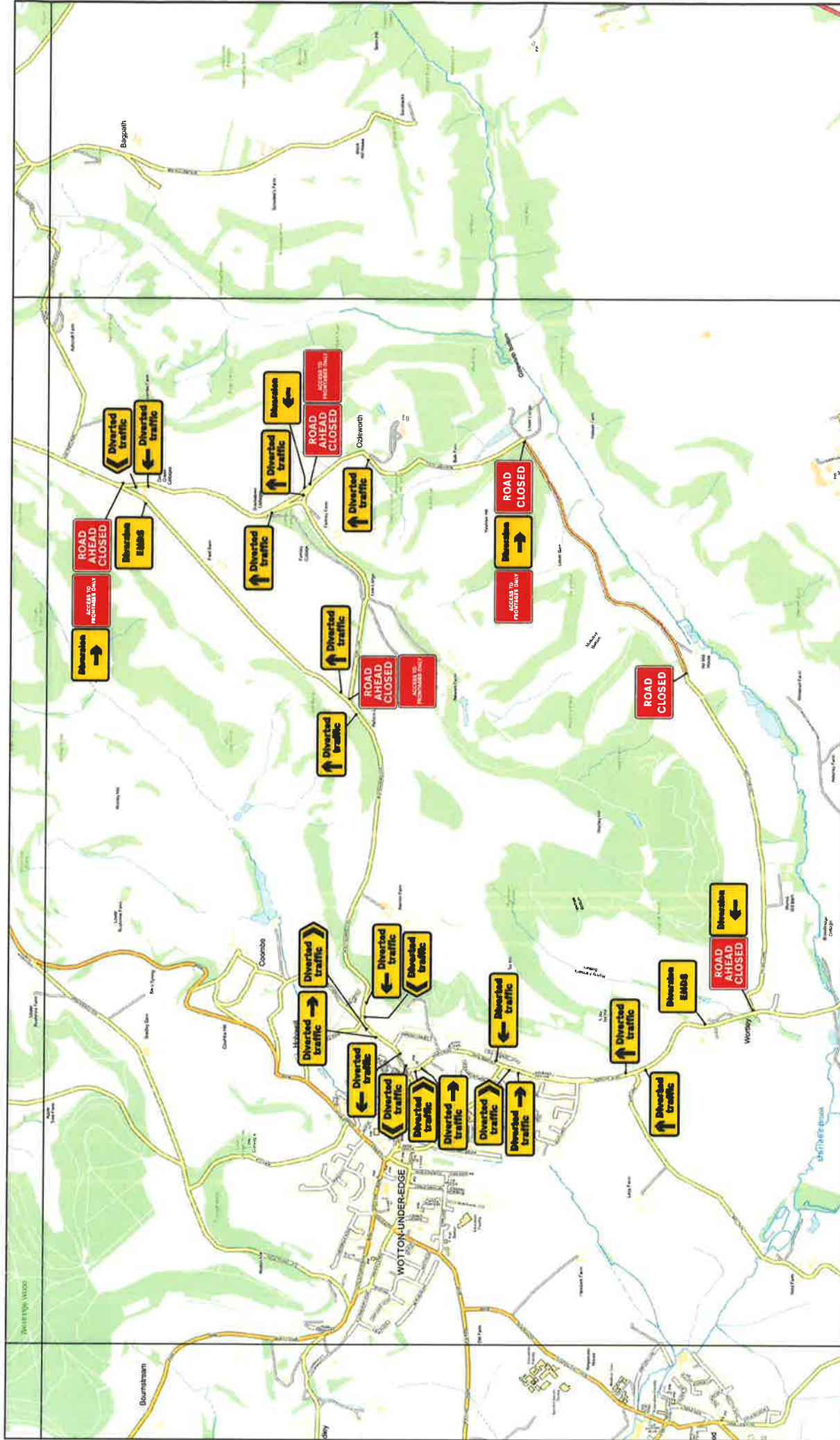

 LINK Highway Services workflow@linkhs.co.uk	SITE ADDRESS: Hill Mill Lane, GL12 7QP	DATE:	13/12/2019	CLIENT: 
		DRAWN BY:	ED	
		CHECKED BY:	JK	
		PHASE:		
		PROJECT NO:	SW-AEREY	



 workflow@linkhs.co.uk		SITE ADDRESS:		DATE:		13/12/2019		CLIENT:	
		Hill Mill Lane, GL12 7QP		DRAWN BY:	ED				
CHECKED BY:	JK								
PHASE:									
		PROJECT NO:	SW-AEREY						