

- Airlock**
1. Airlock system to be installed at Road Closure point.
 2. Road Closure/Works Access is to be closed off with Barrier and to be manned at all times.
(If Barrier is not available for any reason then close cone this section)
 3. 1m vehicle to be forward facing towards the Road closure point at all times.
 4. Not at any point do you put yourself in danger and try to physically stop a vehicle from entering site.
 5. Any queries about this set up Please speak to your Foreman/Supervisor.

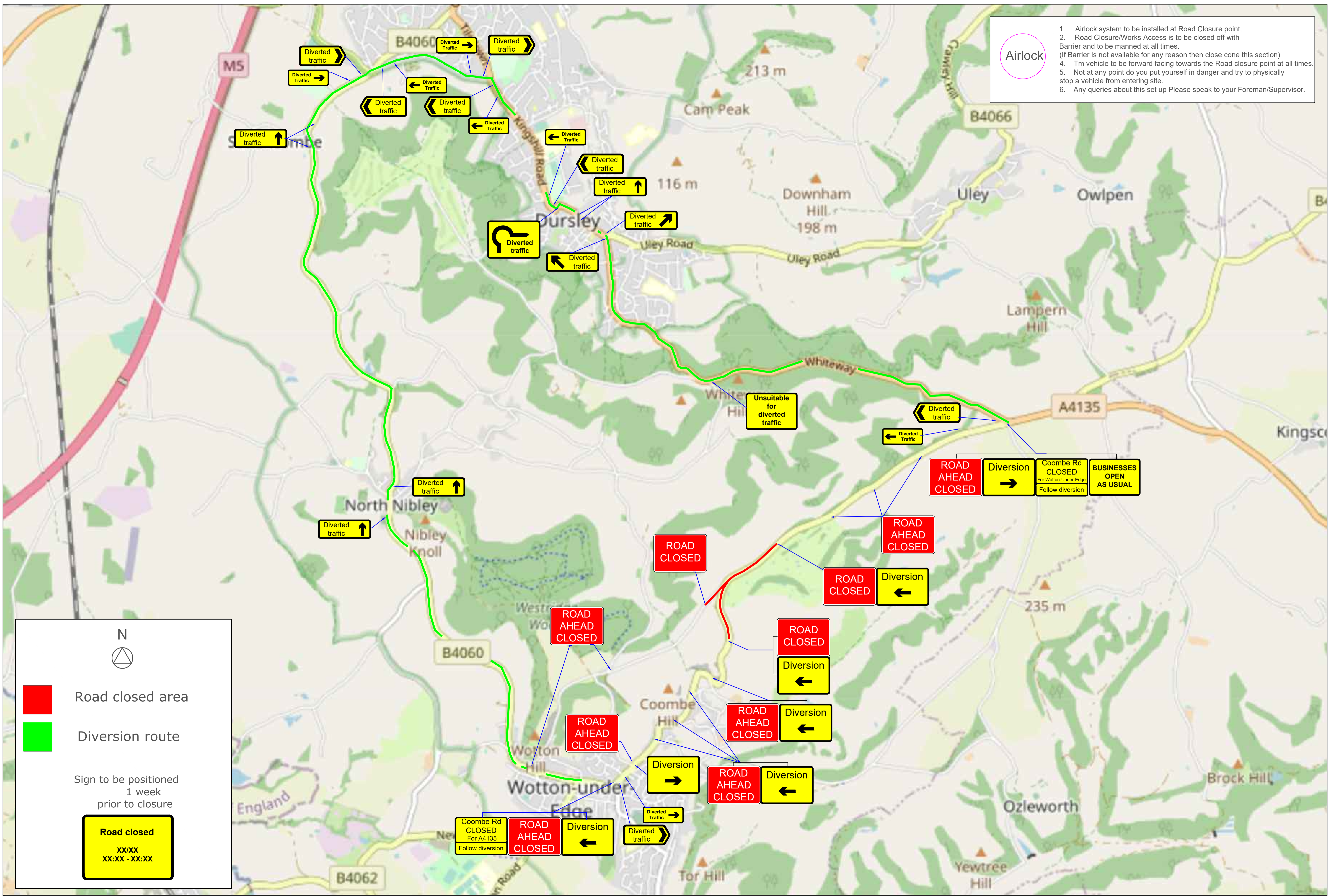

N

Road closed area
 Diversion route

Sign to be positioned 1 week prior to closure